



# SERVICE BULLETIN

## SB1247

<b>ADDRESSEES</b>	: Owners and operators of coaches listed under 'Application'
<b>VEHICLE MODEL</b>	: TD925
<b>SYSTEM/SUBSYSTEM</b>	: Traction engine-Fuel system
<b>BULLETIN TYPE</b>	: Safety Recall NHTSA 12V-505
<b>DATE</b>	: November 27, 2012
<b>SUBJECT</b>	: <b>Fuel Pro-filter compartment – To install thicker base plate</b>
<b>TERMS &amp; CONDITIONS</b>	: Refer to the warranty section further in this Bulletin.

### **APPLICATION:**

The recall campaign, subject of this Bulletin is applicable to following units:

<b>Model</b>	<b>VIN</b>
TD925	42494 → 42629

### **DESCRIPTION:**

1. In the event of a tag axle left tire blow out, the debris might damage the Fuel Pro filter compartment base plate. If this base plate cannot withstand the impact from the debris, the drain valve and/or water-in-fuel sensor fitted at the bottom of the Fuel Pro filter might be damaged. With running engine, this damaged drain valve and/or water in fuel sensor allows fuel to leak and spread into the engine compartment, thus increasing the risk for a potential fire hazard.
2. On the recalled vehicles it is necessary to fit a thicker stainless steel base plate. This plate will provide sufficient protection to the Fuel Pro filter should any tire blow out occur. For this purpose, thicker plates have been made available. Refer to the procedure in this Service bulletin for fitting instructions. The terms and conditions of the campaign have been detailed in the warranty section.

*Continued on next page*

## **MATERIAL:**

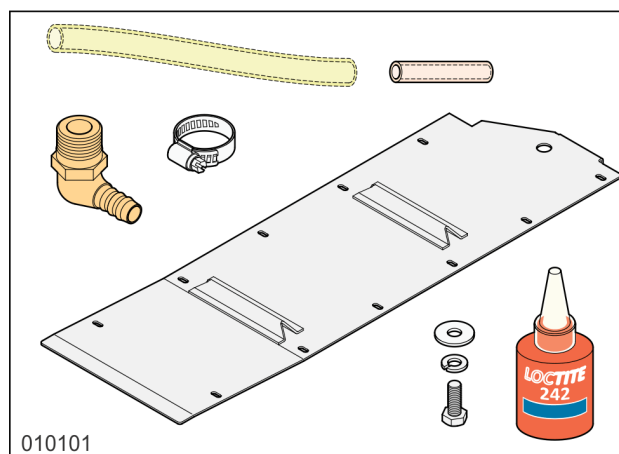

**Figure 1**

VH reference	Description	Qty.
11247681	Fuel Pro filter compartment base plate - 3 mm thick	1
90854A135	Cap screw M6 x 20 Class 10.9 Zinc Steel	13
660623501	Washer M6	13
660636302	Lock washer M6	13
91458A111	Loctite 242 locking compound, .02 oz, Blue	1
53525K57	Brass 90 Deg Barbed Elbow for 3/8" Hose ID x 1/2" NPTF Male Pipe	1
5552K27	Fuel Yellow Tygon PVC Tubing 3/8" ID, 1/2" OD	2
5388K14	Hose Clamp 7/32" to 5/8" Range, 5/16" Band Width	3
53945K31	Rigid Clear PVC Tubing, 1/4" ID x 3/8" OD x 1/16" Wall Thickness	2

Material may be obtained through regular channels.

## **PROCEDURE: To install thicker base plate**

### **1. General:**

- Job technician's qualifications/expertise: body and trim repair.

### **2. Special tools, equipment or services:**

- This job does not require special tools, equipment nor services.

### **3. Preparations:**

- Park the vehicle safely, apply the parking brake, stop the engine, switch off all systems and turn off the master switch on the dashboard.
- Turn off the mechanical battery switch.
- Put a "DO NOT OPERATE" tag on the instrument panel.
- Read the entire procedure before beginning to work.
- Observe safe shop practices at all times.

*Continued on next page*

#### 4. To install thicker base plate:

- 1) Remove and discard the existing base plate, bolts and washers.
- 2) Remove and discard the existing drain hose and barbed fitting from the bottom of the Fuel Pro filter drain valve.
- 3) Install the 90 Deg barbed elbow onto the bottom of the Fuel Pro filter drain valve. Point the barbed section towards the engine.
- 4) Install the yellow fuel hose onto the barbed elbow and secure with a clamp.
- 5) Fully insert the two inch of rigid PVC tubing into the free end of the yellow fuel hose.
- 6) Install a clamp over the free end of the yellow fuel hose and secure it 1  $\frac{3}{4}$ " away from the end (Figure 2).

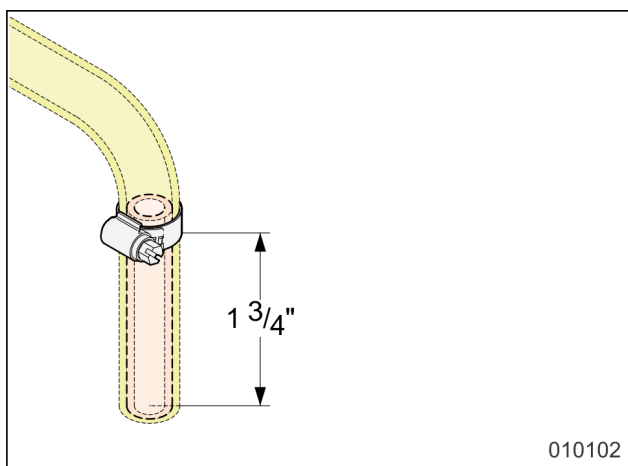

**Figure 2**

- 7) Install the new 3 mm thick base plate using M6 x 20 Class 10.9 cap screws, M6 lock washers, and M6 washers (Figure 3).

*NOTE: The two outboard screw holes must be match drilled in the plate. Coat the screw threads with Loctite 242 and tighten to a torque of 100 in-lbs. If any of the nutsert threads are stripped, drill it out and install the screw with a suitable nut and washer on the top side.*

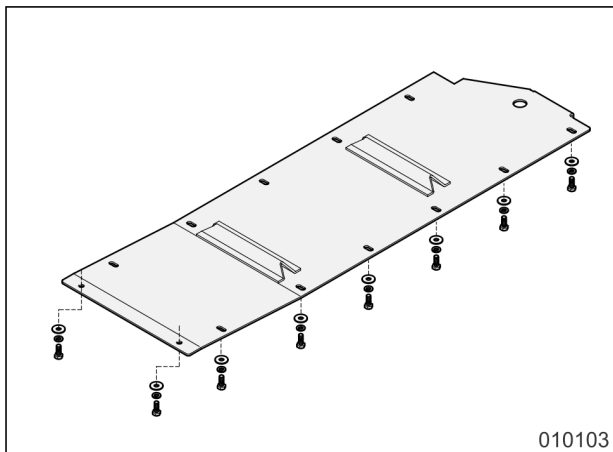

**Figure 3**

- 8) Stick the end of the yellow fuel hose through the small hole in the base plate and secure a clamp at the end to hold it in place.

*Procedure complete.*

#### **ATTACHMENTS:**

None

#### **WARRANTY:**

##### **1. Application:**

The recall campaign, subject of this Bulletin is applicable to following units:

Model	VIN
TD925	42494 → 42629

##### **2. Terms and conditions:**

**CAUTION:** Owners are required to certify on and return the OWNER'S CERTIFICATION LETTER, which has been included with the Owner Notification Letter that the recall remedy has been carried out in accordance with the manufacturer's instructions.

Van Hool/ABC-Companies will accept warranty claims for this repair as follows:

##### **Parts:**

- Supply: parts will be supplied through regular channels, free of charge.
- Return: none

**Labor allowance:** 2.25 hours of labor will be awarded per unit repaired.

**Campaign expiration/target date:** Service Bulletin issue date + 1 year

##### **3. Claim references:**

- Job code: S00028S

**Claim submission:** If there are any questions regarding this campaign, please call ABC Customer Care & Parts Source toll-free for guidance on 1-877-427-7278. Listen for the prompts for warranty and select that option.

#### **INFORMATION HANDLING:**

Important supplements to and modifications of the technical information not yet included in the Van Hool manuals are communicated by means of Service Bulletins.

File the Service Bulletins at the back of your manual, in numerical order.

To make sure that you will be reminded of the Bulletins that have appeared in the meantime while paging the manual, mark the pages concerned by hand with the Service Bulletin number.