

LEFT CONSOLE PANEL

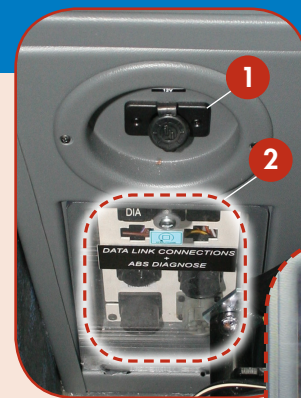

- 1 12V socket
- 2 Data link connections



DOOR CONTROLS



- 1 Entrance door emergency release
- 2 Passenger door override control valve



ENTRANCE DOOR PANEL

- 1 Luggage compartment lock
- 2 Luggage compartment lighting
- 3 Blank
- 4 Guide reading lighting



CONTROL PANEL IN ENGINE COMPARTMENT

- 1 "Force Regeneration" button
- 2 "Regeneration inhibit" button
- 3 Start engine button
- 4 Stop engine button
- 5 24V light socket
- 6 Engine compartment light
- 7 Starting interlock switch

INTERIOR WHEELCHAIR LIFT COMPARTMENT



- 1 Wheelchair passenger lighting
- 2 Threshold warning system module
- 3 Lift door emergency air release knob
- 4 Lift spotlight
- 5 Belt cutter
- 6 Lift door emergency handle

WHEELCHAIR LIFT SYSTEM



MANUAL BYPASS KNOBS

- 1 In
- 2 Out
- 3 Up
- 4 Down
- 5 Power switch



CONTROL PENDANT

- 1 Up
- 2 Down
- 3 Stow
- 4 Deploy

ABC CUSTOMERCARE SERVICE 24/7

ABC CustomerCare
Van Hool Technical Support
Emergency Roadside Assistance
Toll-free 877-427-7278
www.abc-companies.com/care.asp



www.abc-companies.com



VANHOOL TX45 DRIVER'S GUIDE

Version Two: VIN# 41295 – 41...



Exclusive U.S. VANHOOL Distributor

TX45

DRIVER'S GUIDE

CONSOLE PANEL & DOOR CONTROLS

- 1 Cruise control
- 2 Cruise control RES/ACCEL & SET/COAST
- 3 Jake Brake
- 4 Automatic Slip Reduction (ATC)
- 5 Engine Stop Override
- 6 Transmission shift pad



MULTIFUNCTIONAL CONTROL

- 1 Drivers window control
- 2 Blank
- 3 Passenger climate control
- 4 Driver's climate control
- 5 Interior lighting
- 6 Joystick
- 7 Exterior mirrors
- 8 "ESC" key

COMBINATION SWITCH ON STEERING COLUMN

- 1 Turn signal, high/low beam lever
- 2 Windshield washer
- 3 Horn
- 4 Windshield wiper control



DRIVER'S FLOORBOARD AREA

- 1 Steering column adjustment



CENTER INSTRUMENT PANEL

- | | |
|--------------------------------------------------------------------------------|-------------------------------------------------------------|
| 1 Master switch indicator (green) | 20 Active regen indicator |
| 2 Parking brake applied (red) | 21 Guide call |
| 3 Low beam headlights activated (green) | 22 Stop requested |
| 4 High beam headlights activated (blue) | 23 Cruisecontrol on |
| 5 Left turn signal activated (green) | 24 Techograph failure |
| 6 Serious fault light (red) | 25 Retarder Failure |
| 7 Minor fault light (yellow) | 26 Transmission failure |
| 8 Right turn signal activated (green) | 27 Speedometer |
| 9 Pressure in compressed air tank of brakes low | 28 Odometer |
| 10 All passenger doors closed (green);
Not all passenger doors closed (red) | 29 Multifunctional display messages
• Air pressure gauge |
| 11 DPF regeneration required | 30 Outside temperature |
| 12 Wheelchair lift requested | 31 Average mile per gallon |
| 13 Luggage doors not closed | 32 Tachometer |
| 14 ABS fault indicator | 33 DEF gauge |
| 15 Turn signals of ski-box/luggage trailer | 34 Fuel gauge |
| 16 Alternator failure | 35 Multiplex function buttons |
| 17 Pressure in compressed-air system low | 36 Coolant temperature gauge |
| 18 Rear fog lights on | 37 Engine oil pressure gauge |
| 19 Exhaust aftertreatment system failure | |



RIGHT SWITCH PANEL

- 1 Hazard lights
- 2 Driver's cab lighting
- 3 Reading lights
- 4 Passenger compartment lighting
- 5 Blank
- 6 120 Volt
- 7 Exterior mirror heating
- 8 Sun shades
- 9 Guide call system on/off
- 10 Front kneeler
- 11 Tag axle unloading system
- 12 Raise/lower from normal ride height
- 13 Wheelchair (option)
- 14 Engine fast idle
- 15 Passenger chime control
- 16 Blank
- 17 Blank
- 18 Master switch
- 19 Starter switch
- 20 Vent
- 21 Tire monitoring display
- 22 Passenger front door open/close
- 23 Passenger rear door open/close (optional)
- 24 Exterior lighting
- 25 Fog lights
- 26 Perimeter lighting
- 27 Docking lights



- 28 A/V control head
- 29 Blank
- 30 Blank
- 31 Blank
- 32 Blank
- 33 Auxiliary heater
- 34 LDW lane departure warning
- 35 Blank

This guide applies to Van Hool TX models, year 2013 and newer. Effective as of 2/1/15.

Vehicle specifications subject to change without notice. All information, illustrations, and specifications contained in this guide are based on the latest product information available at the time of production. The right is reserved to make changes at any time without notice.

Please refer to all owner, operations, maintenance, or parts manuals and associated documentation for further information.